

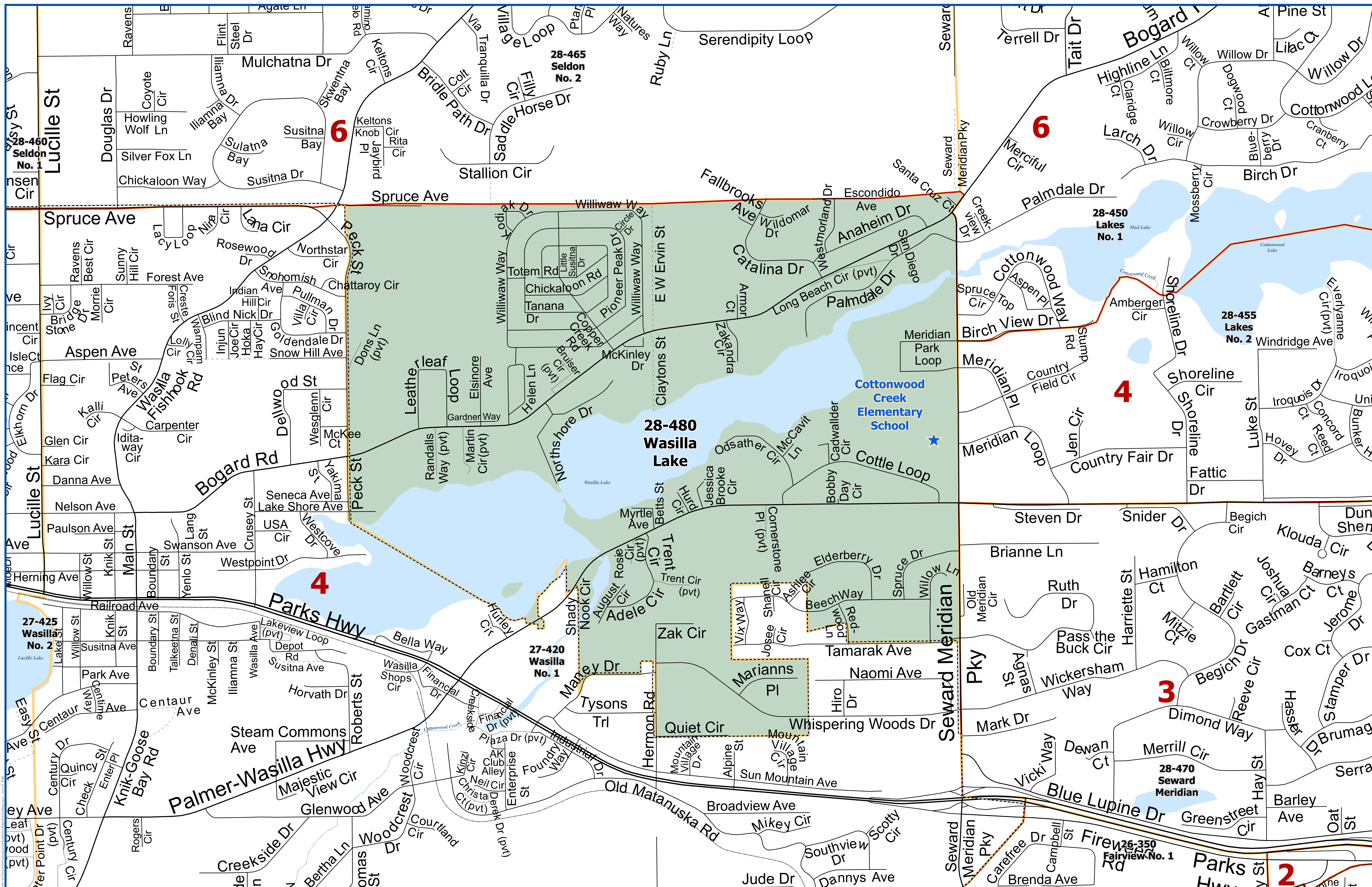

# Matanuska-Susitna Borough Voting Precincts

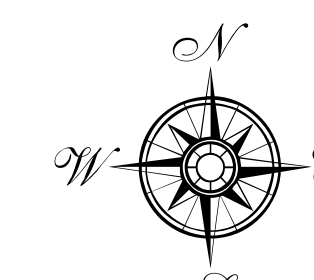

- Polling Location
- City Boundaries
- Voting Precincts
- Assembly District Boundaries
- Matanuska Susitna Borough Boundary
- Roads
- Highway
- Major
- Medium
- Minor
- Private
- Primitive
- Not Constructed
- Railroad
- Major Waterbodies
- Streams

Precinct # 28-480 Wasilla Lake  
 Poll Location:  
**COTTONWOOD CREEK ELEMENTARY SCHOOL**  
 800 N. Seward Meridian Parkway

Prepared by MSB  
 IT Department - GIS Division  
 Data Sources: Matanuska-Susitna Borough,  
 State of Alaska Division of Elections

June 2026

